

The Transatlantic Land Use Conference

Westin Washington, DC, City Center
September 24-26, 2007



Conference Program

**Conference on the Science and Education of Land Use:
A transatlantic, multidisciplinary and comparative approach**



**Association for European
Life Sciences Universities (ICA)**



Conference Planning Committee

Dr. Stephan J. Goetz, Professor of Agricultural and Regional Economics and Director, The Northeast Regional Center for Rural Development, The Pennsylvania State University, International Conference Chair

Dr. Floor Brouwer, Head, Research Unit, Natural Resource Management, LEI Wageningen University and Research Centre (WUR), International Conference Vice-Chair

Dr. Lori Lynch, Associate Professor of Agricultural and Resource Economics, University of Maryland, Chair of Local Organizing Committee

USA Committee Members:

Dr. Adesoji Adelaja, Hannah Distinguished Chair and Director, Land Policy Institute, Michigan State University

Dr. John Bergstrom, Russell Professor of Public Policy, Agricultural and Applied Economics, University of Georgia

Dr. Virginia H. Dale, Oak Ridge National Laboratory Corporate Fellow and Group Leader, Landscape Ecology and Regional Analysis Group, and Adjunct Professor of Ecology and Evolutionary Biology, University of Tennessee

Dr. Charles Geisler, Professor, Department of Development Sociology, Cornell University

Dr. Paul D. Gottlieb, Associate Professor and Extension Specialist, Rutgers University

Dr. Jeffrey Kline, Research Forester, USDA Forest Service, Pacific Northwest Research Station, Corvallis, Oregon

Dr. Gerhardus Schultink, Professor, Community, Agriculture, Recreation and Resource Studies, Michigan State University

Dr. James S. Shortle, Distinguished Professor of Agricultural and Environmental Economics, The Pennsylvania State University

European Committee Members:

Dr. Helmut Geist, Chair in Human Geography, University of Aberdeen, Scotland

Dr. Tom Veldkamp, Professor and Scientific Director, Alterra, Green World Research (WUR)

Dr. Hubert Wiggering, Director, Leibniz-Centre for Agricultural Landscape Research University of Potsdam

Other Key Conference Contacts:

Dr. Michael Bowers, National Program Leader, USDA-Cooperative State Research, Education, and Extension Service (CSREES) Natural Resources and Environment

Ms. Pamela A. Hearn, Business and Web Manager, The Northeast Regional Center for Rural Development, The Pennsylvania State University

Dr. Simon Heath, Secretary General, Association for European Life Science Universities (ICA)

Ms. Pamela K. Hileman, Staff Assistant, The Northeast Regional Center for Rural Development, The Pennsylvania State University

Dr. Fen Hunt, National Program Leader, USDA-CSREES Economic and Community Systems

Dr. Ian Maw, Vice President, Food, Agriculture and Natural Resources, National Association of State Universities and Land-Grant Colleges (NASULGC)

Conference Overview

Sunday, September 23, 2007

6:00 – 8:00 PM Early Registration (West Room)

Monday, September 24, 2007

7:15 AM – 5:00 PM Registration (Ballroom Foyer)

7:30 – 8:30 AM Breakfast (Ballroom Foyer)

8:30 – 10:00 AM Official Welcome and Introductions (National Ballroom A)
Plenary Session I: Comparative Overview

10:00 – 10:30 AM Break (Ballroom Foyer)

10:30 AM – 12:00 noon Plenary Session II (3 comparative papers, US/Europe)

12:00 noon – 1:30 PM Lunch (National Ballroom A)

1:30 – 3:00 PM Concurrent Papers, Session I

3:00 – 3:30 PM Break (Ballroom Foyer)

3:30 – 5:00 PM Concurrent Papers, Session II

5:00 PM Dinner on your own

Tuesday, September 25, 2007

7:15 AM – 5:00 PM Registration (Ballroom Foyer)

7:30 – 8:30 AM Breakfast (Ballroom Foyer)

8:30 – 10:00 AM Plenary Session III (3 comparative papers, US/Europe)

10:00 – 10:30 AM Break (Ballroom Foyer)

10:30 AM – 12:00 noon Concurrent Papers, Session III

12:00 noon – 1:30 PM Lunch (Ballroom)
Award Ceremony for Student Paper Competition

1:30 – 3:00 PM Concurrent Papers, Session IV

3:00 – 3:30 PM Break (Ballroom Foyer)

3:30 – 5:00 PM Concurrent Papers, Session V

5:00 PM Dinner on your own

Wednesday, September 26, 2007

7:15 AM – 12:00 noon Registration (Ballroom Foyer)

7:30 – 8:30 AM Breakfast (Ballroom Foyer)

8:30 – 10:00 AM Concurrent Papers, Session VI

10:00 – 10:30 AM Break (Ballroom Foyer)

10:30 AM – 12:00 noon Plenary Wrap-up and Next Steps
(conference formal program ends)

12:00 noon – 5:00 PM Post-Conference Study Tour



Conference on the Science and Education of Land Use:
A transatlantic, multidisciplinary and comparative approach

PROGRAM OVERVIEW (schematic)

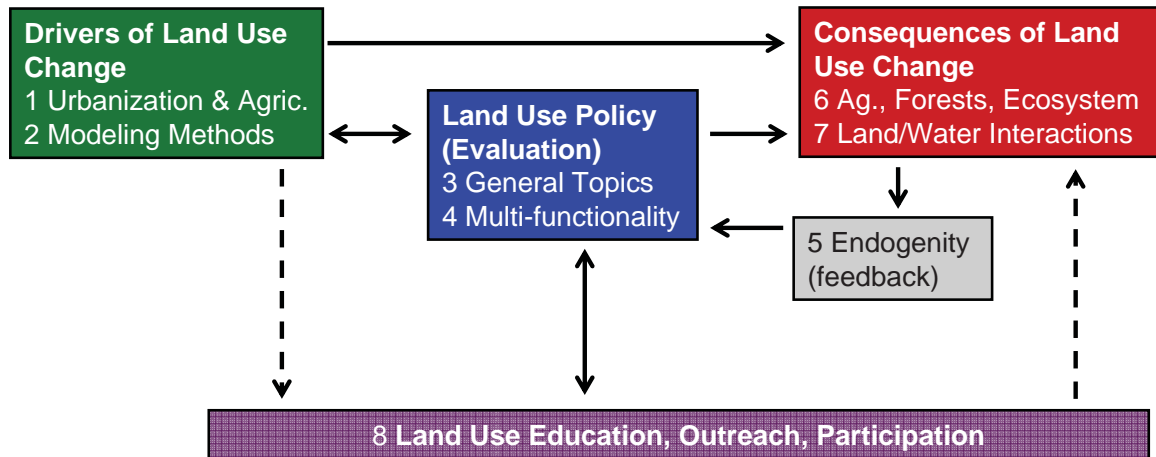

Conference Program

Sunday, September 23, 2007

6:00 – 8:00 PM

Early Registration (West Room)

Monday, September 24, 2007

7:15 AM – 5:00 PM

Registration (Ballroom Foyer)

7:30 – 8:30 AM

Breakfast (Ballroom Foyer)

8:30 – 10:00 AM

Official Welcome and Introductions, Ballroom A, Dr. Franklin E. Boteler, Moderator

Dr. Franklin E. Boteler, Deputy Administrator for Economic and Community Systems,
USDA-CSREES

Dr. Ian Maw, Vice-President (NASULGC) and Dr. Simon Heath, Secretary General, Association
for European Life Science Universities (ICA)

Dr. Gale Buchanan, Under Secretary for Research, Education, and Economics, United States
Department of Agriculture

Plenary Session I: Comparative Overview

*P-1 Analysis and Modelling of Change in Land Use Systems as Exemplars of Coupled
Natural and Human Systems*, Richard Aspinall, Macaulay Institute

*P-2 Understanding Urbanization: A Comparative Review of Land Use Change Models
and Data Sources*, C. Dawkins, Virginia Tech; and S. Lewis and G. Knaap, University of
Maryland at College Park

10:00 – 10:30 AM

Break (Ballroom Foyer)

10:30 AM – 12:00 noon

Plenary Session II: Comparative papers, US/Europe, Dr. Walt Armbruster, Farm Foundation,
Moderator

P-3 Tools for Ex-ante Assessment of Agricultural and Environmental Policies: SEAMLESS,
Martin van Ittersum, Wageningen University; Floor Brouwer, Frank Ewert, Thomas
Heckelei, Johanna Alkan Olsson, Erling Andersen, Irina Bezlepkina, Marcello Donatelli,
Lennart Olsson, Jacques Wery, Jan Erik Wien, Joost Wolf

- P-4 ***Sustainability Impact Assessment Tools (SIAT) for European Analysis: SENSOR***, Stefan Sieber, Peter Verweij, Dirk M. Wascher, and Marta Perez-Soba, Alterra; Klaus Müller, Katharina Helming, Karen Tscherning, Bettina König and Hubert Wiggering, Leibniz-Centre for Agricultural Landscape Research; Tom Kuhlman, Agricultural Economics Research Institute; Paul Tabbush, Forestry Commission Research Agency; Oliver Dilly, Chair of Soil Protection and Recultivation; Hanne Bach, National Environmental Research Institute
- P-5 ***Changing Landscapes: Developing a Comprehensive Land Use/Land Cover Program for the Commonwealth of PA***, Doug Miller, Eric Warner, Joseph Bishop, and Wayne Myers, Center for Environmental Informatics and Office for Remote Sensing and Spatial Information Resources, Pennsylvania State University
-

12:00 noon – 1:30 PM

Lunch (Ballroom)

Lunch Speaker: Dr. Wilfrid Legg, Head of Policies and Environment Division, OECD Agriculture Directorate 1, ***Payments for Environmental Services from Farming: What is the Role for Governments? An OECD Perspective***

1:30 – 3:00 PM

Concurrent Papers, Session I

1. Ashlawn South; Moderator: Virginia Dale; Discussant: Mark Partridge

Drivers of Land Use Change: Urbanization and Agriculture (1-A)

1. ***Insights from Transatlantic Comparative Studies on Land Use and Political Driving Forces: The Example of Massachusetts, USA-Switzerland***, Anna M. Hersperger and Matthias Bürgi, Swiss Federal Research Institute

2. ***Comparison of Land Use Changes Due to Urban Growth in St. Louis Metropolitan Area (USA) and Greater Copenhagen Area (Denmark)***, Henry N.N. Bulley, University of Nebraska; Anne G. Busck, Søren P. Kristensen, and Søren Præstholt, University of Copenhagen; Samrita Lohani, University of Missouri

3. ***The Footprint of Exurban Development: A US/UK Comparison***, A. Bruce Dotson, University of Virginia

2. Woodlawn Room; Moderator: Jim Shortle; Discussant: Tom Kuhlman

Land Use Policy Evaluation: General (3-A)

4. ***Ecological Networks to Balance Development and Conservation: Examples from Land Use Planning in the Netherlands, USA and Argentina***, Hubert van Lier and Gerrit J. Carsjens, Wageningen University

5. ***Castles or Cattle? Community Economics and Policy Alternatives in the Competition for Ranch Open Space Values***, Andrew Seidl, Lindsey Ellingson, and CG Mucklow, Colorado State University; Nicholas Magnan, University of California-Davis

6. *Hedonic Valuation of Alternative Land Protection Methods in the Rural-Urban Fringe*, Robert Kling, T. Scott Findley, Emin Gahramanov, and David Theobald, Colorado State University

7. *Small Feet, Big Tracks: The Potential Economic Effects of Critical Habitat Designation on the Economy of Southeastern Wyoming*, Thomas Foulke, D. Taylor and R. Coupal, University of Wyoming

3. **West Room:** Moderator: Michael Bowers; Discussant: Yaoqi Zhang

Consequence of Land Use Change: Agriculture, Forests and Other Ecosystems (6-A)

8. *Urban Influence on Farmland Values and Costs of Production: The Corn Belt, the South, and the Plains States: A Farm-Level Analysis*, Richard N. Nehring, Kenneth W. Erickson, and Vince Breneman, US Department of Agriculture

9. *Economics of Soil Carbon Sequestration Through Biomass Crops*, Madhu Khanna, Hayri Onal, Basanta Dhungana, and Michelle Wander, University of Illinois

10. *Human and Ecosystems Interaction and its Ecological Impacts in Mountains: Lesson from Scenario Development in Himalayas of India*, S. Nautiyal and H. Kaechele, Leibniz-Centre for Agricultural Landscape Research (ZALF)

4. **Stratford Hall:** Moderator: Soji Adelaja; Discussant: Thomas Berger

Land Use Education, Outreach and Participation/Participatory Methods (8-A)

11. *One Step at a Time: Incremental Implementation of a Water Quality Permit Program*, Dennis Collentine, Gävle University

12. *Overarching Values as Sustainability Indicators for Stakeholder-based Land Use Curriculum*, Tim Collins, Western Illinois University

13. *Exploring Impacts of Land-use Change and Resident Land-management Behavior on Water Quality in the Potomac Gorge, USA via Participatory Modeling*, Dawn Parker, Robin Brake, Ryan Albert, Susan A. Crate and R. Christian Jones, George Mason University; Giselle Mora-Bourgeois, Urban Ecology Research Learning Alliance

3:00 – 3:30 PM

Break (Ballroom Foyer)

3:30 – 5:00 PM

Concurrent Papers, Session II

5. **Ashlawn South:** Moderator: Virginia Dale; Discussant: Bruce Dotson

Drivers of Land Use Change: Urbanization and Agriculture (1-B)

14. *Future Farmland Requirements in a Densely Populated Area: The Case of Flanders in Europe*, Valerie Vandermeulen, Ghent University

15. *What Drives Land-Use Changes Across the US? A Regional Analysis of Landowner Decisions*, Ruben Lubowski, USDA Economic Research Service; Andrew J. Plantinga, Oregon State University; and Robert N. Stavins, Harvard University

16. *Geography of US Peri-Urban Agricultural Adaptation*, Jill Clark, Jeff S. Sharp, and Darla K. Munroe, Ohio State University; Douglas Jackson-Smith, Utah State University
17. *Urbanization Impacts on the Soil Resources in the Nanjing/Shanghai Corridor*, Eric Warner and G. W. Peterson, Pennsylvania State University; Xuezheng Shi, Academy of Science in Nanjing

6. Woodlawn Room: Moderator: Jim Shortle; Discussant: Andy Seidl

Land Use Policy Evaluation: General (3-B)

18. *Evaluating Land Use Plan Quality*, Philip Berke and David Godschalk, University of North Carolina
19. *The Impact of Policies on Land Use: Developing Indicators for Environmental, Social and Economic Sustainability*, Tom Kuhlman, Agricultural Economics Research Institute
20. *Using Market Values for Targetting Ecologically Valuable Natural Resource Land: An Application to Maryland's GreenPrint Program*, Karen Palm and Lori Lynch, University of Maryland
21. *Incorporating Land Use Change and Development into Landscape Planning and Ecological Assessments in the Upper Deschutes Area, Oregon (USA)*, Jeff Kline and Miles Hemstrom, USDA Forest Service; and Gary Lettman, Oregon Department of Forestry

7. West Room: Moderator: Michael Bowers; Discussant: Richard Nehring

Consequence of Land Use Change: Agriculture, Forests and Other Ecosystems (6-B)

22. *Change of Forest Ecosystems in the Long Sweep of History: An Economic Perspective*, Yaoqi Zhang, School of Forestry and Wildlife Sciences, Auburn University
23. *Spatially Locating Threats to the Environmental Contributions of Forest Land in the USA*, Ronald E. McRoberts, Northern Research Station, U.S Forest Service, and Susan Stein, Cooperative Forestry Staff, State and Private Forestry, U.S. Forest Service
24. *Lake Water Quality in Maine's Changing Landscape*, Megan Tylka, K. Bell, and Katherine Webster, University of Maine

8. Stratford Hall: Moderator: Soji Adelaja; Discussant: John Warbach

Land Use Education, Outreach and Participation/Participatory Methods (8-B)

25. *Integrating Biodiversity and Economic Values in the Planning and Design of Ecosystem Networks*, C. Martijn van der Heide and Arianne T. de Blaeij, LEI Public Issues Division; Willemien Geertsema, Alterra and Land Use Planning Group
26. *Water Services, Stakeholder Preferences and Conflicting Interests: Importance of Public Participation in Water Management*, Dennis Collentine, Gävle University and Paola Sabina Lupo Stanghellini, University of Trento

5:00 PM: Dinner on your own

Tuesday, September 25, 2007

7:15 AM – 5:00 PM

Registration (Ballroom Foyer)

7:30 – 8:30 AM

Breakfast (Ballroom Foyer)

8:30 – 10:00 AM

Plenary Session III: Comparative papers, US/Europe, Dr. Selma Lewis, University of Maryland, Moderator

- P-6 *Connecting Land Use Decision Makers to Their Changing Landscape: Integration of Research with Tools, Training and Outreach at U. of CT*, Chester Arnold, Center for Land Use Education and Research, Department of Extension; DanCivco, Center for Land Use Education and Research, Natural Resources Management and Engineering Department; John Rozum, Nonpoint Education for Municipal Officials Program; Sandy Prisløe, Geospatial Technology Program
- P-7 *Accommodating Land Use Change in the Coastal Zone: The Challenges of Linking Science-to-Management to Achieve Sustainable Ecosystems*, Richard DeVoe, South Carolina Sea Grant Consortium; Geoffrey I. Scott, A. Fred Holland, and Paul A. Sandifer, National Oceanic and Atmospheric Administration; Gary S. Kleppel, State University of New York
- P-8 *Linking Land-Use Science to Decision Making: Strategies and Opportunities*, Virginia Dale, Oak Ridge National Laboratory, Oak Ridge, Tennessee
-

10:00 – 10:30 AM

Break (Ballroom Foyer)

10:30 – Noon

Concurrent Papers, Session III

9. Ashlawn South: Moderator: Richard Aspinall; Discussant: Henry Bulley

Drivers of Land Use Change: Urbanization and Agriculture (1-C)

27. *What are the Determinants of Brownfields Regeneration? An Analysis of Brownfields in England*, Alberto Longo and Danny Campbell, Queen's University, Belfast

28. *Employment Growth in the American Urban Hierarchy: Long Live Distance*, Mark Partridge, Ohio State University; Dan S. Rickman, Oklahoma State University; Kamar Ali and M. Rose Olfert, University of Saskatchewan

29. *About the Validity of the Urban Monocentric Model in the Netherlands*, Thomas de Graaff, Vrije Universiteit Amsterdam; Raymond J.G.M. Florax, Purdue University; Frank van Oort, Utrecht University

10. Woodlawn Room: Moderator: David Kay; Discussant: Nelson Bills

Land Use Policy Evaluation: Agriculture, Multi-functionality and Agri-environmental programs (4-A)

30. *Policy Impacts on Farmland Values at the Urban Fringe: The Case of Ontario's Greenbelt*, Brady Deaton and Richard Vyn, University of Guelph

31. *Using the Past to Create a Sustainable Future for Agriculture: Impact of Federal Farm Policy on Environmental and Social Landscape Change in Iowa*, Paul Brown and Lisa Schulte, Iowa State University

32. *Evaluation of Agricultural Land Preservation Programs*, Lori Lynch, University of Maryland; Wayne Gray and Jacqueline Geoghegan, Clark University

33. *Compliance with Standards in European Agriculture vis-à-vis Main Competitors on the World Market*, Floor Brouwer and Roel Jongeneel, LEI Wageningen University

11. West Room: Moderator: Fen Hunt; Discussant: Ronald McRoberts

Consequence of Land Use Change: Agriculture, Forests and Other Ecosystems (6-C)

34. *LCLU Change Interactions with Climate in Northern Eurasia: International Cooperation and Education Activities in the NEESPI Program*, Garik Gutman, NASA Headquarters

35. *Land Use Transitions, Demographic Change and Perceptions of Place: Penn State Transitional Zone Ecosystem Initiative*, Jill Findeis, Pennsylvania State University

36. *Land Transformation Along the Wildland Urban Interface: Analyzing Urbanization Patterns and Ecosystem Impacts on Northeast Ohio*, Dudley Bonsal, University of Minnesota

12. Stratford Hall: Moderator: Gerhardus Schultink; Discussant: Tim Collins

Land Use Education, Outreach and Participation/Participatory Methods (8-C)

37. *Agent-Based Land Use Models for Teaching, Extension and Collaborative Learning*, Thomas Berger and Pepijn Schreinemachers, University of Hohenheim

38. *Sustainable Land Care: A Case Study of Forest Landowner Cooperation and the Forest Landcare Industry in Virginia, USA*, Bruce Hull, David Robertson, and Sarah Ashton, Virginia Tech

39. *Two Models of Land Use Education Pedagogy*, John Warbach, Soji Adelaja, and Wayne Beyea, Michigan State University

12:00 noon – 1:30 PM

Lunch (Ballroom)

Award Ceremony for Student Paper Competition

Dr. Hayo Haanstra, Senior Policy Advisor on Environment, Ministry of Agriculture,
The Netherlands

1:30 – 3:00 PM

Concurrent Papers, Session IV

13. Ashlawn South: Moderator: Richard Aspinall; Discussant: Anna Hersberger

Drivers of Land Use Change: Urbanization and Agriculture (1-D)

40. *Drivers of Postsocialist Cropland Abandonment in Romania*, Daniel Müller, University of Bonn; Tobias Kuemmerle, Humboldt University, Berlin; Patrick Griffiths, Institute of Geography

41. *Land Use Planning, Sustainability, and Security in Terrains of Terror*, Charles Geisler and David Kay, Cornell University

42. *Tropical Land Use and Land Cover Change as Affected by Rural Immigration; A Case Study from Indonesia*, Joerg A. Priess and Matthias Mimler, University of Kassel; Robert Weber and Heiko Faust, University of Goettingen

14. Woodlawn Room: Moderator: Roel Jongeneel; Discussant: Brady Deaton

Land Use Policy Evaluation: Agriculture, Multi-functionality and Agri-Environmental Programs (4-B)

43. *Designing Efficient Agri-Environmental Schemes Under Consideration of the Common Agricultural Policy (CAP) in Europe*, Bettina Matzdorf and Klaus Müller, Institute for Socio-economics; Christian Kersebaum and Joachim Kiesel, Institute of Landscape Systems Analysis; Thomas Kaiser, Institute of Land Use Systems and Landscape Ecology

44. *Agri-Environmental Programs in the US and the EU*, Nelson Bills, Cornell University; Christina von Haaren, University of Hanover

45. *Multifunctionality and Land Use Policy: An Application of Nonmarket Valuation to Urban Fringe Farm and Forest Preservation*, Joshua Duke, University of Delaware; Robert Johnston, University of Connecticut

46. *Agri-Environmental Measures as an Instrument to Enhance Sustainability-Farm Level and Budget Implications from a Case Study Region in Germany*, Sandra Uthes, Leibniz-Centre for Agricultural Landscape Research

15. West Room: Moderator: Fen Hunt; Discussant: Jill Caviglia-Harris

Consequences of Land Use Change: Land/Water Interactions (7-A)

47. *Estimating the Effects of the EU Common Agricultural Policy on Ground and Surface Water Quality: Case Study in the Neckar Basin*, Thomas Gaiser and Martin Henseler, University of Hohenheim

48. *Land Use Impacts on Estuarine Areas in South Carolina and the Southeast Region, USA: An Overview*, M. Richard DeVoe and Denise M. Sanger, South Carolina Sea Grant Consortium; A. Fred Holland, National Oceanic and Atmospheric Administration; Dwayne S. Porter, University of South Carolina

49. *Managing Coastal Urbanization and Development in the 21st Century: Balancing Human Dimensions and Environmental Quality Issues*, Geoffrey I. Scott and A. Fred Holland, National Oceanic and Atmospheric Administration; M. Richard DeVoe, South Carolina Sea Grant Consortium; Dwayne S. Porter, University of South Carolina

16. Stratford Hall: Moderator: Gerhardus Schultink; Discussant: Ruben Lubowski

Drivers of Land Use Change: Modeling Methods (2-C)

50. *A Multi-Agent Model for Agricultural Land Use and Land Development Decisions in Rural South China*, Lin Zhang and Jill Findeis, Pennsylvania State University

51. *Agent-Based Modeling of HIV/AIDS and Land-Use Dynamics in South-Eastern Uganda*, Maction Komwa, Dawn Parker, and Kathryn H. Jabonsen, George Mason University; Pepijn Schreinemachers and Thomas Berger, University of Hohenheim

52. *Modelling Land Use Changes Using Cellular Automata. An Example from the North China Plain*, Frank Bode and Reiner Doluschitz, International Research Training Group

3:00 – 3:30 PM

Break (Ballroom Foyer)

3:30 – 5:00 PM

Concurrent Papers, Session V

17. Ashlawn South: Moderator: John Bergstrom; Discussant: Darla Munroe

Drivers of Land Use Change: Modeling Methods (2-A)

53. *Lessons and Challenges for Land Change Modelers as Revealed by a Comparison of Thirteen Cases*, Robert Pontius, Jean-Christophe Castella, Keith Clarke, Ton de Nijs, Charles Dietzel, Duan Zengqiang, Eric Fotsing, Noah Goldstein, Kasper Kok, Eric Koomen, Christopher D. Lippitt, William McConnell, Bryan Pijanowski, Alias Mohd Sood, A. Tom Veldkamp, and Peter H. Verburg, Clark University

54. *Spatial Models of Land Use Change: The Role of Local Spillovers as Drivers of Open Space Loss*, Richard Ready, Simanti Banerjee, and Nga P. Nguyen, Pennsylvania State University

55. *Demographic, Economic, Environmental, and Political Determinants of Irreversible Land Development in the US*, Scott Templeton, Clemson University

18. Woodlawn Room: Moderator: Paul Gottlieb; Discussant: Kathleen Bell

Policy - Addressing Endogeneity Issues: Goals and Preferences (5-A)

56. *Measuring the Effects of Growth Controls on New Residential Development*, Antonia Bento and Charles Towe, University of Maryland; Jacqueline Geoghegan, Clark University

57. *Local Road Spending and Urban Sprawl: An Analysis of the Causal Relation in the Detroit Metropolitan Area*, Annalie Campos and Soji Adelaja, Michigan State University

58. *Economic Development, Paddy Field Loss and Rice Output in China*, Liu Pinghui, East China Institute of Technology, and Wu Ziping, Queen's University of Belfast

19. West Room: Moderator: Jeffrey Kline; Discussant: Geoffrey Scott

Consequences of Land Use Change: Land/Water Interactions (7-B)

59. *Linkages Between Land Cover and the Environmental Conditions in Tidal Creeks*, Denise M. Sanger, South Carolina Sea Grant Consortium, and A. Fred Holland, National Oceanic and Atmospheric Administration

60. *A Multi-Disciplinary Approach to Modeling the Impacts of Land Use Change on Vernal Pool-breeding Amphibians*, Robb Freeman, University of Maine

61. *Forest Clearing and Soil Degradation Rethinking the 'Cycle of Abandonment' on the Amazonian Forest Frontier*, Luke Jones, University of Tennessee; Jill L. Caviglia-Harris, Salisbury University

20. Stratford Hall: Moderator: Stefan Sieber; Discussant: Richard Iovanna

Drivers of Land Use Change: Modeling Methods (2-D)

62. *Land Use Simulation in the North China Plain Under Different Scenarios - An Integrated GIS Approach*, Yunhui Liui and Zhenrong Yu, China Agricultural University; Frank Bode and Reiner Doluschitz, University of Hohenheim

63. *Transaction Costs and Intergovernmental Cooperation in Land Use*, Soji Adelaja and Laila Racevskis, Michigan State University

64. *Simulating the Diffusion of Agricultural Innovations with Multi-agent Systems: An Empirical Application to Northern Thailand*, Pepijn Schreinemachers and Prasnee Tipraqsa, Chiang Mai University; Thomas Berger, University of Hohenheim

5:00 PM: Dinner on your own

7:15 AM – 12:00 noon

Registration (Ballroom Foyer)

7:30 – 8:30 AM

Breakfast (Ballroom Foyer)

8:30 – 10:00 AM

Concurrent Papers, Session VI

21. East Room: Moderator: John Bergstrom; Discussant: Scott Templeton

Drivers of Land Use Change: Modeling Methods (2-B)

65. *Predicting Urban Growth Patterns in the Coastal Southeastern United States*, Jeffery Allen, Clemson University; Kang Shou L, Towson University

66. *The Importance of Land Heterogeneity in Trade Liberalization Analysis*, A. Tabeau and B. Eickhout, Netherland Environmental Assessment Agency; H. van Meijl, Agricultural Economics Research Institute

67. *Market Clearing in Agent-Based Models of Conversion: A Bid-Rent Function*, Richard Iovanna, USDA and Colin Vance, RWI Essen

22. Woodlawn Room: Moderator: Paul Gottlieb; Discussant: Richard Aspinall

Addressing Endogeneity Issues: Goals and Preferences (5-B)

68. *Public Preferences for Protecting Working Landscapes*, Kathleen Bell, University of Maine

69. *The Future of Farmland Preservation Programs: From Retention and Viability to Resiliency*, Soji Adelaja, Manuel Colunga-Garcia, Melissa Gibson, and Mary Beth Lake, Michigan State University

70. *Enforcing a Holistic Approach to Rural Landscape Economic Valuation as Support to Landscape Planning and Policy Making*, G. Hutchinson, A. Longo, and C. Tagliaferro, Queen's University Belfast

23. West Room: Moderator: Jeffrey Kline; Discussant: Robb Freeman

Consequences of Land Use Change: Land/Water Interactions (7-C)

71. *The Importance of Physical Processes in Land Use Planning*, Jack Blanton and Julie Anft, Skidaway Institute of Oceanography, Willard S. Moore, University of South Carolina; Samantha Joye and Pedro Leitão, University of Georgia; Francisco Andrade, University of Lisbon; M. Adelaide Ferreira, Instituto do Mar

72. *Chemical Contaminants Entering Estuaries of the South Atlantic Bight and Determining Their Effects by Bioassays*, Richard F. Lee, Skidaway Institute of Oceanography; G. Thomas Chandler, University of South Carolina; Michael Fulton, National Oceanic and Atmospheric Administration, and Keith Maruya, Southern California Coastal Water Research Program

73. *Land Use Policy and Flood Risk: A Comparison Between the American and Dutch Experiences*, Vanessa E. Daniel and Piet Rietveld, Vrije Universiteit; Raymond J.G.M. Florax, Purdue University

74. *Exploring Possible Spatial Planning Scenarios in the Context of Potential Sea-level Rise in the Netherlands; Dealing with the Uncertainties of Climate Change*, W. Loonen and E. Koomen, Netherland Environmental Assessment Agency and Vrije Universiteit Amsterdam

24. Stratford Hall: Moderator: Stefan Sieber; Discussant: Dawn Parker

Drivers of Land Use Change: Modeling Methods (2-E)

75. *Multiscale Processes Underlying Residential Land Conversion in Periurban Areas*, Darla Munroe, Elena G. Irwin, and Jill K. Clark, Ohio State University

76. *Multi-Scale Integrated Analysis of Land Use Change*, Peter H. Verburg, Koen P. Overmars, Martha Bakker, and Louise Willemen, Wageningen University

77. *On the Rate of Land Development when Developers and Conservationists are Engaged in a Dynamic Lobbying Game*, John Janmaat, University of British Columbia

10:00 – 10:30 AM

Break (Ballroom Foyer)

10:30 AM – 12:00 noon

Plenary Wrap-up and Next Steps (conference formal program ends)

12:00 noon

Study Tour Begins

Speaker Biographies

Dr. Franklin E. Boteler

Dr. Franklin E. Boteler is the Deputy Administrator for Economic and Community Systems in the Cooperative State Research, Education, and Extension Service, at the U.S. Department of Agriculture (USDA). Dr. Boteler received his B.S. degree in Psychology from the University of Maryland; M.F.R. and Ph.D. degrees in Forest Resource Management from Pennsylvania State University. Prior to joining USDA, from 1998 until his selection to Deputy Administrator in April 2005, Dr. Boteler served as the Deputy Director of the Washington State Parks and Recreation Commission, based in Olympia, Washington. He was the Deputy Director of the Idaho Department of Parks and Recreation, based in Boise, Idaho, from 1991-98.

From 1987-91, Dr. Boteler served as the Chief of the Planning and Assessment Section of the North Carolina Division of Parks and Recreation, based in Raleigh, North Carolina. He was an associate professor of forestry at West Virginia University in Morgantown from 1979-87. From 1973-75, he worked in Washington, D.C., and Hagerstown, Maryland, as a counselor for teens at risk.

Dr. Gale Buchanan

Dr. Buchanan received the B.S. and M.S. degrees in Agronomy from the University of Florida in 1959 and 1962, respectively, and the Ph.D. in Plant Physiology, with minors in Botany and Agronomy, from Iowa State University in 1965. Dr. Buchanan spent the first 21 years of his professional career with Auburn University in the Department of Agronomy and Soils, with primary teaching and research responsibilities in weed science. He served as Dean and Director of the Alabama Agricultural Experiment Station from October 1, 1980 to September 30, 1985. On April 14, 1986, he was appointed Associate Director of the Georgia Agricultural Experiment Stations and Resident Director of the Coastal Plain Experiment Station. He served as Interim Director of the Georgia Agricultural Experiment Stations from June, 1994 to February, 1995. He became Dean and Director of the College of Agricultural and Environmental Sciences March 1, 1995 up to 2006. Currently, he serves as the USDA-Under Secretary for Research, Education, and Economics.

Dr. Hayo Haanstra

Dr. Haanstra has worked with the Ministry of Agriculture, Nature and Food Quality as a senior policy adviser on environment since 2001. In that capacity he is the Dutch focal point for IPCC working group II on vulnerabilities, impacts and adaptation and responsible for climate change research initiatives of the ministry. He is also involved in the development of Eururalis, an instrument for identifying long term changes in land use in Europe, and responsible for organising the European discussion on this issue. Dr. Haanstra worked with the Ministry of Housing, Spatial Planning and Environment as a senior policy adviser responsible for the international climate change negotiations specialised in the flexible mechanisms (Joint Implementation, Clean Development Mechanism and Emission trading) from 1996-2001. He also participated in the Dutch delegations from Kyoto (1997) up to Marrakech (2001) and in the presidency team supporting Minister Pronk during the sixth Conference of the Parties to the UNFCCC in The Hague (2000).

Dr. Simon Heath

Dr. Heath is Secretary General of the Association for European Life Science Universities (ICA): www.ica-europe.info. ICA's mission is to stimulate and support research through the development of concerted actions and in engaging globally, and to represent the general interest of its members at the European level. Formerly he was senior lecturer and the Director of the Centre for Computer Based Learning in Land Use and Environmental Sciences (CLUES) at the University of Aberdeen (UK). Dr. Heath received a PhD from the University of Reading (UK) in Agronomy.

Dr. Wilfred Legg

Dr. Legg is Head of the Policies and Environment Division in the OECD Agriculture Directorate, where he has been since 1981, after working as a research fellow in Sussex University. His main areas of expertise are in agricultural and environmental policy analysis, and in measuring and evaluating agricultural policy developments, using the internationally recognised measures of support to agriculture (the Producer and Consumer Support Estimates) that he helped develop. He was President of the Agricultural Economics Society for the year 2003-2004 and presented his Presidential address that was entitled Agricultural Subsidies: Measurement and Use in Policy Evaluation.

Dr. Ian Maw

Dr. Ian Maw currently serves as Vice President, Food, Agriculture and Natural Resources, National Association of State Universities and Land-Grant Colleges (NASULGC). He received his B.S. from Indiana State College, M.S. from Pennsylvania State University, and Ph.D. from Pennsylvania State University. Dr. Maw's academic interests have spanned the areas of counseling psychology, higher education management and administration, student affairs, curriculum development and implementation, and most recently systemic change in higher education. He has participated on numerous national committees under broad auspices of USDA and NASULGC, and served as Chair of the Academic Programs Sections of the Board of Agriculture for the term 1996-1997. He has edited and/or authored a number of papers, articles and books in the areas of his interests.

Notes

Notes

Index of Participants

Numbers refer to paper numbers (not pages) in the program schedule.

Adelaja, Soji 39, 57, 63, 69
Allen, Jeffery 65
Arnold, Chester P6
Aspinall, Richard P1
Bell, Kathleen 24, 68
Berger, Thomas 37, 51, 64
Bills, Nelson 44
Bode, Frank 52, 62
Bonsal, Dudley 36
Brouwer, Floor P3, 33
Brown, Paul 31
Bulley, Henry 2
Campos, Annalie 57
Caviglia-Harris, Jill 61
Clark, Jill 16, 75
Collentine, Dennis 11, 26
Collins, Tim 12
Dale, Virginia P8
Dawkins, Casey P2
de Graaff, Thomas 29
Deaton, B. James 30
DeVoe, Richard P7, 48, 49
Dotson, A. Bruce 3
Duke, Joshua 45
Erickson, Kenneth 8
Findeis, Jill 35, 50
Foulke, Thomas, 7
Freeman, Robert 60
Gaiser, Thomas 47
Geoghegan, Jacqueline 32, 56
Godschalk, David 18
Gutman, Garik 34
Hersperger, Anna 1
Hull, R. Bruce 38
Iovanna, Richard 67
Jackson-Smith, Douglas 16
Janmaat, Johannus 77
Jones, Luke 61
Jongeneel, Roel 33
Kay, David 41
Khanna, Madhu 9
Kline, Jeffrey 21
Kling, Robert 6
Komwa, Maction 51
Koomen, Eric 74, 53
Kuhlman, Tom 19, P4
Lee, Richard 72
Lewis, Selma P2
Longo, Alberto 27, 70
Loonen, Willem 74
Lubowski, Ruben 15
Lynch, Lori 20, 32
Matzdorf, Bettina 43
McRoberts, Ronald 23
Miller, Douglas P5
Moore, Willard 71
Müller, Daniel 40
Munroe, Darla 16, 75
Nautiyal, Sunil 10
Nehring, Richard 8
Parker, Dawn 13, 51
Partridge, Mark 28
Pinghui, Liu 58
Pontius, Robert 53
Porter, Dwayne 48, 49
Priess, Joerg 42
Ready, Richard 54
Sanger, Denise 48, 59
Schreinemachers, Pepijn 37, 51, 64
Scott, Geoffrey P7, 49
Seidl, Andrew 5
Sieber, Stefan P4
Tabeau, Andrzej 66
Tagliafierro, Carolina 70
Templeton, Scott 55
Tylka, Megan 24
Uthes, Sandra 46
van der Heide, C. Martijn 25
Vandermeulen, Valerie 14
van Lier, Hubert 4
Veldkamp, A. Tom 53
Willemen, Louise 76
Vyn, Richard 30
Warbach, John 39
Warner, Eric P5, 17
Zhang, Yaoqi 22
Zhang, Lin 50

**Transatlantic Land Use Conference Schedule
September 24-26, 2007, Washington, DC**

	Ashlawn South/East Room	Woodlawn Room	West Room	Stratford Hall
Monday	<i>Breakfast 1</i>			
8:30-10:00 am	Welcome, Introductions, Plenary Session I, Dr. Franklin E. Boteler Official welcome, two overview papers of the issues,			
	<i>Break 1</i>			
10:30-noon	Plenary Session II: Comparative Papers (US/Europe) M: Dr. Walter Armbruster <i>Lunch [Speaker 1]</i>			
1:30-3:00 pm	1. Drivers (1-A) Urbanization & Agric.	2. Policy (3-A) General Topics	3. Consequences (6-A) Ag., Forests, Ecosystems	4. Education (8-A)
	M: Virginia Dale D: Mark Partridge	M: Jim Shortle D: Tom Kuhlman	M: Michael Bowers D: Yaoqi Zhang	M: Soji Adelaja D: Thomas Berger
	<i>Break 2</i>			
3:30-5:00 pm	5. Drivers (1-B) Urbanization & Agric.	6. Policy (3-B) General Topics	7. Consequences (6-B) Ag., Forests, Ecosystems	8. Education (8-B)
	M: Virginia Dale D: Bruce Dotson	M: Jim Shortle D: Andy Seidl	M: Michael Bowers D: Richard Nehring	M: Soji Adelaja D: John Warbach
Dinner on your own (maps, restaurant lists provided)				
Tuesday	<i>Breakfast 2</i>			
8:30-10:00 am	Plenary Session III: Comparative Papers (US/ Europe) M: Dr. Selma Lewis			
	<i>Break 1</i>			
10:30-noon	9. Drivers (1-C) Urbanization & Agric.	10. Policy (4-A) Multi-functionality	11. Consequences (6-C) Ag., Forests, Ecosystems	12. Education (8-C)
	M: Richard Aspinall D: Henry Bulley	M: David Kay D: Nelson Bills	M: Fen Hunt D: Ronald McRoberts	M: Gerhardus Schultink D: Tim Collins
1:30-3:00 pm	<i>Lunch : Award Ceremony for student paper competition</i>			
	13. Drivers (1-D) Urbanization & Agric.	14. Policy (4-B) Multi-functionality	15. Consequences (7-A) Land/ Water Interactions	16. Drivers (2-C) Modeling Methods
	M: Richard Aspinall D: Anna Hersperger	M: Roel Jongeneel D: Brady Deaton	M: Fen Hunt D: Jill Caviglia-Harris	M: Gerhardus Schultink D: Ruben Lubowski
	<i>Break 2</i>			
3:30-5:00 pm	17. Drivers (2-A) Modeling Methods	18. Policy (5-A) Endogeneity	19. Consequences(7-B) Land/ Water Interactions	20. Drivers (2-D) Modeling Methods
	M: John Bergstrom D: Darla Munroe	M: Paul Gottlieb D: Kathleen Bell	M: Jeffrey Kline D: Geoffrey Scott	M: Stefan Sieber D: Richard Iovanna
Dinner on your own (maps, restaurant lists provided)				
Wednesday	<i>Breakfast 3</i>			
8:30-10:00 am	21. Drivers (2-B) Modeling Methods	22. Policy (5-B) Endogeneity	23. Consequences (7-C) Land/ Water Interactions	24. Drivers (2-E) Modeling Methods
	M: John Bergstrom D: Scott Templeton	M: Paul Gottlieb D: Richard Aspinall	M: Jeffrey Kline D: Robb Freeman	M: Stefan Sieber D: Dawn Parker
	<i>Break 1</i>			
10:30-noon	Plenary Wrap-up and Next Steps <i>Tour Begins</i>			

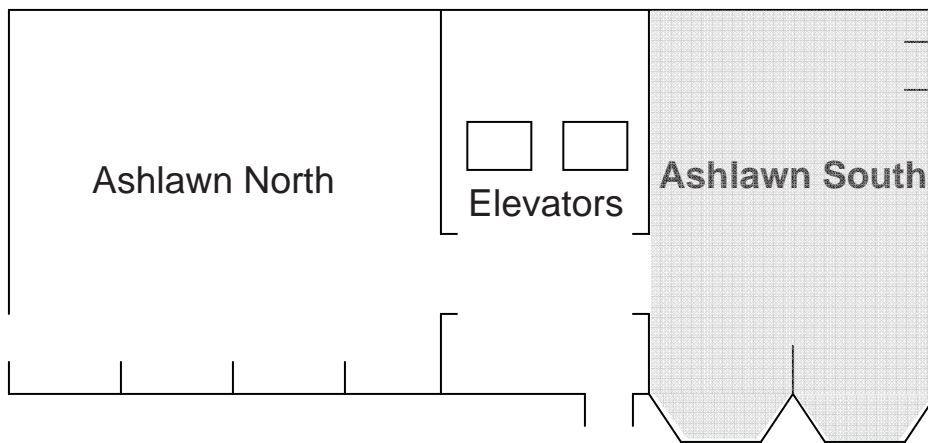

**Lower
Mezzanine**

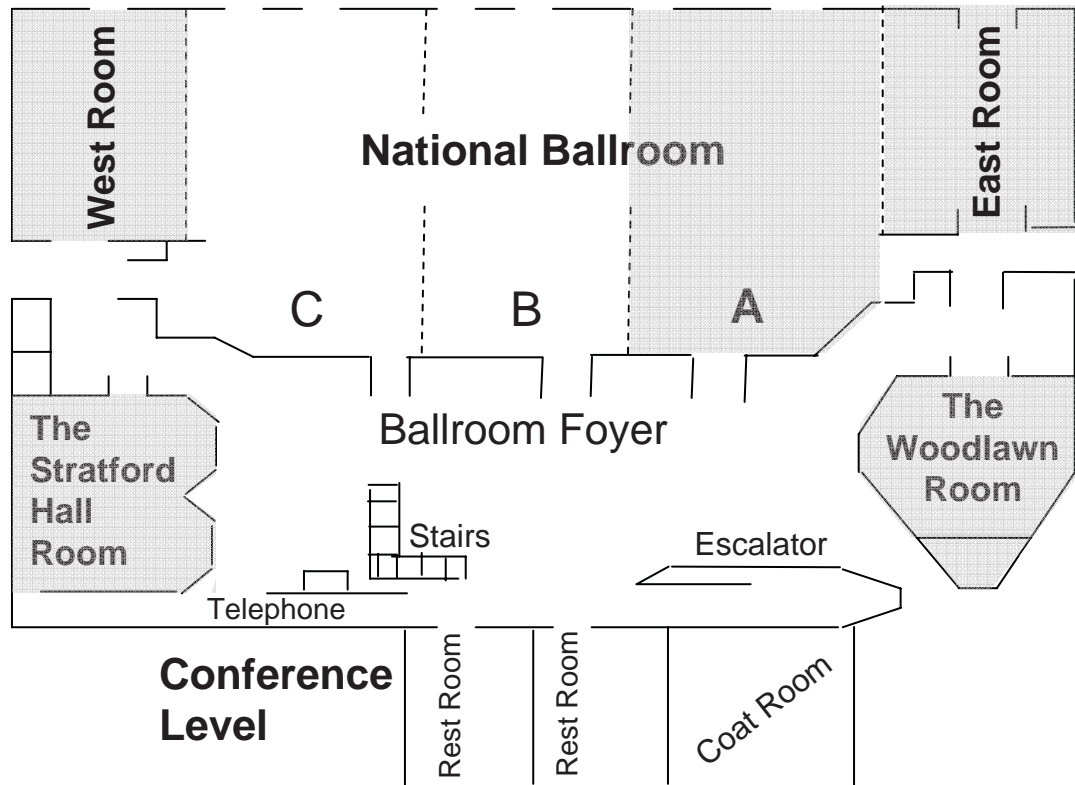



Conference Sponsors

Agricultural Economics Research Institute (LEI),
Wageningen University and Research Centre, The Netherlands

Association for European Life Sciences Universities (ICA)

Farm Foundation

Land Policy Institute

Ministry of Agriculture, Nature and Food Quality, The Netherlands

National Association of State Universities and Land-Grant Colleges (NASULGC)

National Center for Smart Growth Research and Education

Richard B. Russell Foundation/University of Georgia – Athens

Southern Rural Development Center

Swank Program in Rural-Urban Policy

The North Central Regional Center for Rural Development

The Northeast Regional Center for Rural Development

United States Department of Agriculture, Cooperative State Research,
Education, and Extension Service (USDA-CSREES)

Western Rural Development Center